

DE BEVOISE

ADDITION TO STARKE.

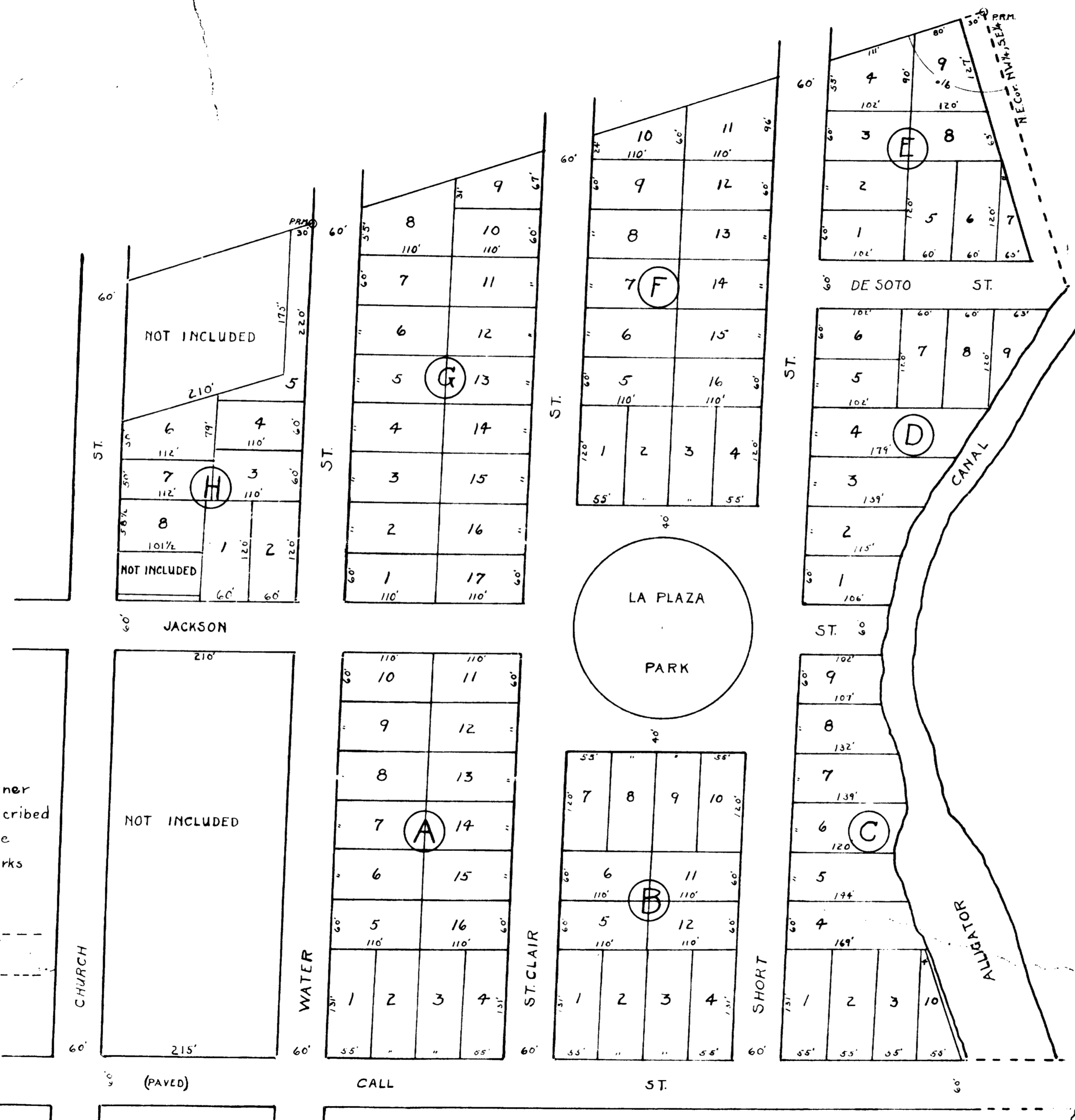
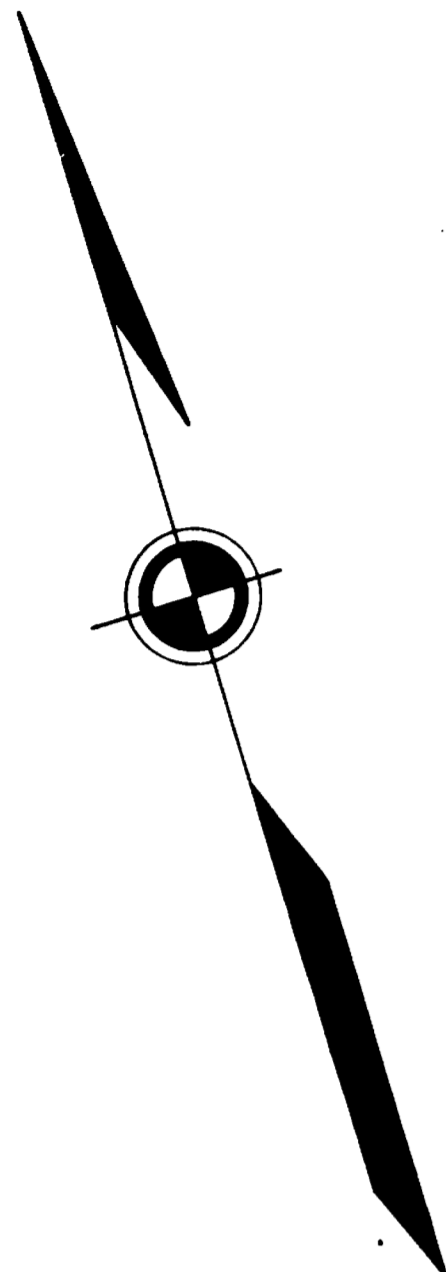

I do hereby certify that I am the owner in fee simple of the land hereon described and do hereby dedicate to the use of the public forever the streets, alleys and parks as shown on this plat.

Witness _____ Owner _____
Witness _____

STATE OF FLORIDA }
COUNTY OF BRADFORD } SS

On this 2 day of Nov A.D. 1925,
before me personally appeared D.C. De Bevoise
to me known to be the persons described in and who executed the foregoing instrument, and severally acknowledged the execution thereof to be a free act and deed for the uses and purposes therein mentioned and the said Lu. De Bevoise the wife of the said D.C. De Bevoise on a separate and private examination taken and made by and before me, and separately and apart from her said husband, did acknowledge that she made herself a party to the said instrument for the purpose renouncing, relinquishing and conveying all her right title and interest, whether of dower or of separate property, statutory or equitable, in and to the lands therein described, and that she executed said instrument freely and voluntarily, and without any constraint, fear, apprehension or compulsion of or from her said husband.

WITNESS my signature and official seal at Starke in the county of Bradford and state of Florida, the day and year last aforesaid.

Notary Public
My commission expires July 11, 1929

Description: Beginning on N. side of Call St. 215' E. of N.E. cor. of Call and Church St., Thence E. on Call St. to Cor. Limits, Thence N.E. along Cor. Limits to E. line of N.W. 1/4 of S.E. 1/4, Thence N. to N.E. cor. of N.W. 1/4 of S.E. 1/4, Thence W. on N. line of N.W. 1/4 of S.E. 1/4 896 ft., Thence S. parallel with Church St. 175 ft., Thence W. 210 ft to Church St., Thence S. along Church St. 158 1/2 ft. to the Lee Place, Thence S. 70 ft. to the Lee Place, Thence S. parallel with Church St. 175 ft. to the Lee Place, Thence E. along Church St. to pair of lot beginning, All in N.W. 1/4 of S.E. 1/4 of Sec. 28 Bradford County, State of Florida.

I do hereby certify that this is a correct representation of the above described land and subdivision thereof, and that permanent monuments have been set as required by law and as shown on this plat.

J.F. Wickham Jr.
Surveyor
Nov. 21 1925. Scale 1" = 100'