

N

Morr

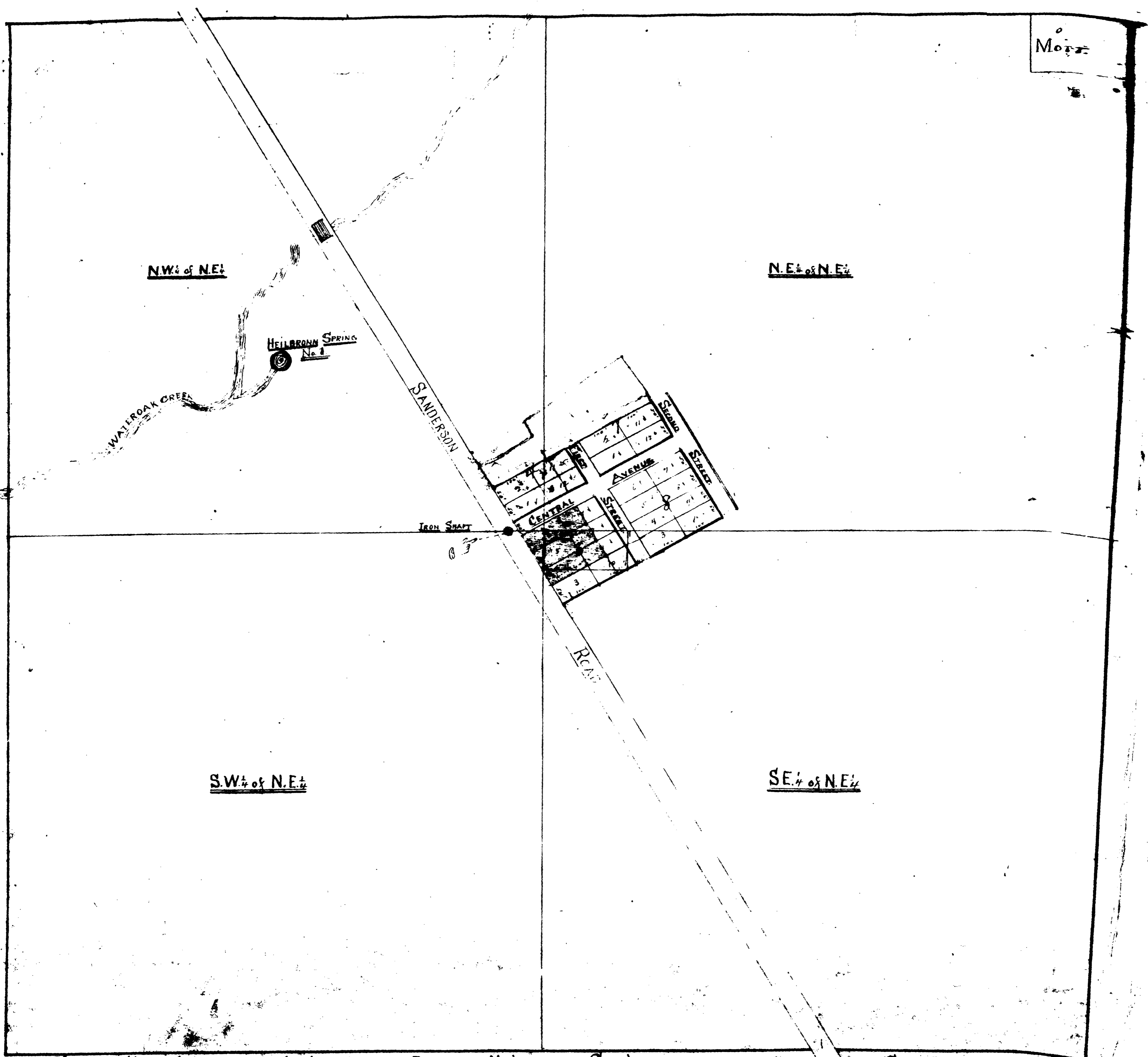

The above platted lands are more particularly described as follows to-wit:

Commencing at an iron shaft in the center of a 2 1/2 ft. hole at the intersection of Sanderson Road which extends not 94 ft. to the north nor or less feet of the southeast corner of the southeast quarter of the northeast quarter of Sec. 36, Twp. 5 S., R. 21 E. and from thence to the center of said shaft with said street or road 25 ft. to a point of beginning; thence by the westerly side of said street for 110 ft.; thence northerly 45 ft. right angles with said street 450 ft.; thence easterly 200 ft. parallel with said street; thence southerly 200 ft. at right angles with said street 450 ft.; thence northerly along said street 200 ft. to the point of beginning.

**PLAT OF HEILBRONN SPRINGS
BRADFORD CO. FLORIDA
BEING PART OF—
SEC. 36, TWP. 5 S., R. 21 EAST.**

SCALE, 160 FT. TO THE INCH

Filed in the office of the Clerk of the Circuit Court for the County of Bradford, State of Florida on the 1st day of March, A. D. 1915 and recorded in Book 41 of said County Public Records of said County.

[Signature]
Clerk

[Signature]
Dept. Clerk

CS