

MAP OF

Peek Addition

TO STARKE BRADFORD COUNTY, FLORIDA.

The same being all the North West Quarter of the Northwest Quarter of Section Twenty Eight (28) Township Six (6) South of Range Twenty Two (22) East North of Third Street except three (3) acres in the Northwest Corner.

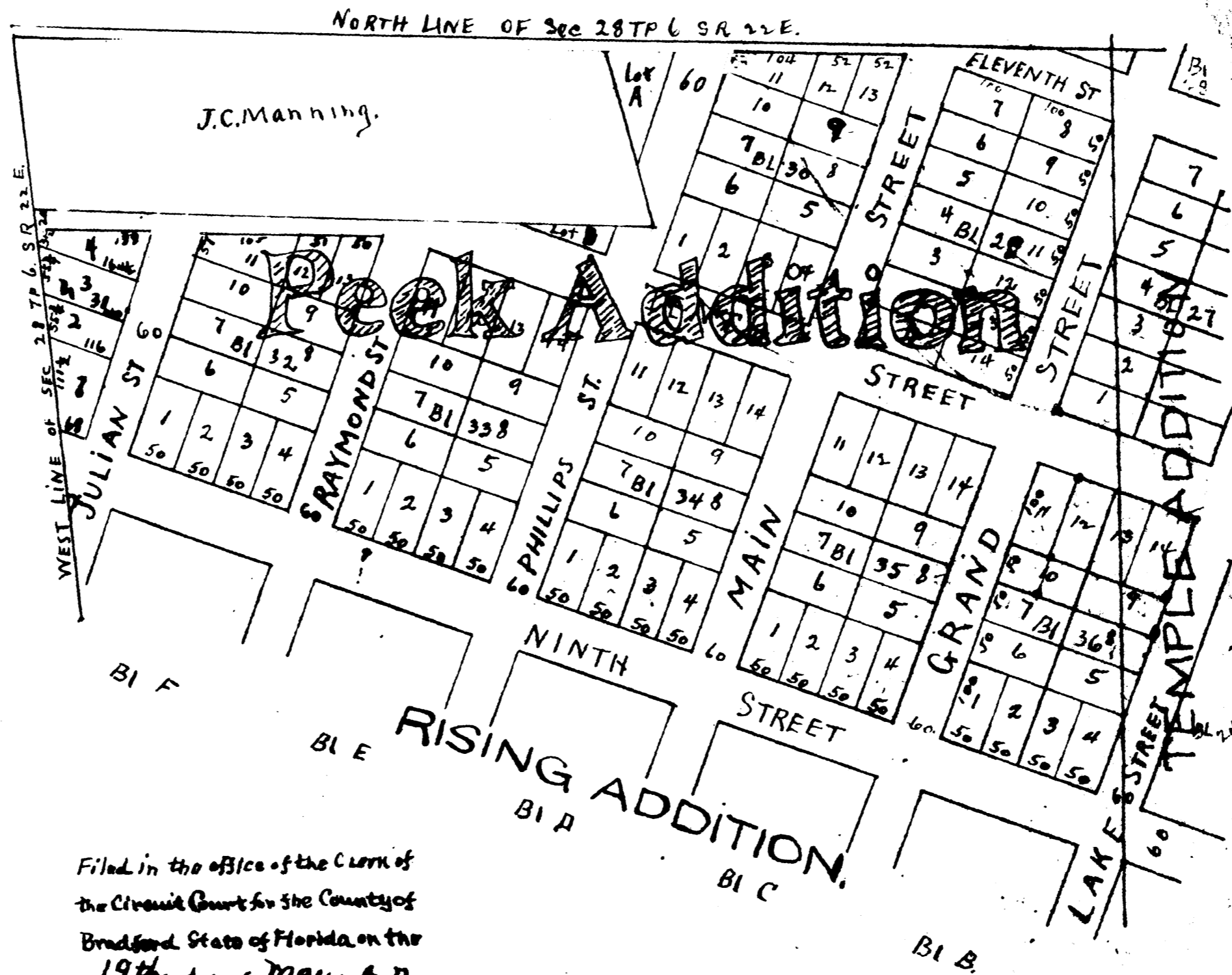

Filed in the office of the Clerk of
 the Circuit Court for the County of
 Bradford, State of Florida on the
 19th day of May A.D.
 1915 and recorded in Book
 # 1 of Map on page 45
 Public Records of said County
 W.D. W. Clerk

By *W.D. W.*
 " Dept. Clerk